

Telefoon (0317) 619 108

www.serviceteam.nl

SERVICE TEAM NEDERLAND



bedrijfskoeling



grootkeukens



witech catering equipment



Item:

***710.060**

***710.060**

EN

Summary

1. Instruction warnings.....	2
2. Safety and Right Use Warning.....	2
3. Warranty.....	2
4. Installation and assembly.....	2
4.1 Components.....	3
5. Cleaning and maintenance.....	5
5.2 Wiring diagram.....	5
6. Disposal.....	6

1. Instruction warnings

The user must hold the whole instructions and store up this document in case of use. The producer does not assume any responsibility for damages incurred due to the failure of improper use of this manual. All measures in this manual are expressed in mm.

2. Safety and Right Use Warning



The manufacturer products meet the latest technological evolutions and current safety guidelines. Thermic box line **GEMMA**, object of this booklet, is projected to be in compliance with directives and field laws, in order to guarantee a safe and reliable product. Any other use will be considered inapposite to the original destination. Producer do not assume any responsibility for damages caused by an improper use. Responsibility lies only on user. A proper use also includes compliance with the instructions for use and installation and any additional documentation as well as the conditions of inspection and maintenance.

3. Warranty

We thank you for purchasing this product, designed and produced for a professional environment. Due to commercial and construction requirements, the manufacturer reserves the right to make changes in order to enhance the quality and use of product, in compliance with European Community legislation, grants its products for 24 months. This guarantee does not include electrical parts, labour and all replacements related to an improper use of the good. Any manipulation carried out automatically excludes the liability of the manufacturer. The products or parts to be replaced or repaired for unequivocal defects in workmanship and materials used must be in a “free port” at the offices of the producer, who after a careful inspection, will repair or replace them. The repairs are carried out exclusively at the headquarters of the manufacturer, and none cost incurred by the customer for repairs will be refunded by the manufacturer unless expressly agreed.

4. Installation and assembly



The manufacturer declines every responsibility of damage of someone or something caused by the failure to comply with the instructions of this manual. After the unpacking of the item from its packing, proceed by removing the adhesive plastic tape before starting up the product. Any residual glue has to be removed carefully (do not use abrasive cleaners). The device is designed to run on AC to the voltage specified on the technical data plate (located on the bottom of the unit). The grounding line is marked by the colours yellow/green and must not be interrupted. The device is provided with a cable in accordance with the CE regulations and with a schuko plug (that can be replaced, when necessary, with a different plug, suitable for the specified wattage and in accordance to the current regulations and guidelines; when necessary, replace the provided cable with a new one with the same features).

Before switching the appliance:

- Check if the electrical system can withstand the appliance's load (WATT as indicated on the technical plate). To switch on the device, turn the thermostat knob on the required temperature (max 90°) then the indicator light will turn on and when the right temperature is reached it will turn off; through the thermostat the selected temperature will be preserved. Turn the knob to the position "0" (OFF) to switch off the device.

WARNING:



Once turned on, the appliance will reach the desired temperature very quickly. In order to avoid any inconvenience, turn the device on only shortly before starting the service and turn it off shortly after the end. Do not make any structural change to the appliance.

4.1 Components

GEMMA						
Ref.	Code	Quantity				Description
		30	60	80	120	
1		2	3	2	3	Chromed steel grid
2		8	12	8	12	Shelf holder
3		1	1	1	1	Magnet
4		/	/	1	1	Left door
5		1	1	2	2	Plastic bag handle
6		2	2	4	4	Screw for handle
7		2	2	4	4	Washer
8		1	1	1	1	Top
9		4	4	4	4	Screw for the top
10		1	1	1	1	Thermostat knob
11		1	1	1	1	Light cover
12		1	1	1	1	Luminous warning light
13		1	1	1	1	Thermostat 30°90°C
14		1	1	1	1	Safety thermostat 150°C
15		1	1	1	1	Schuko cable with plug
16		1	1	1	1	Borne
17		1	1	1	1	Earth
18		1	1	1	1	Heating element

INSTRUCTION MANUAL
ASSEMBLY, INSTALLATION, USE AND MAINTENANCE.

19		1	1	1	1	Protection grid
20		8	8	8	8	Screw for protection grid
21		4	4	4	4	Rubber foot
22*		2	2	2	2	Castors*
23*		2	2	2	2	Castors with brake*

*Not shown in the explode view, these elements are optional

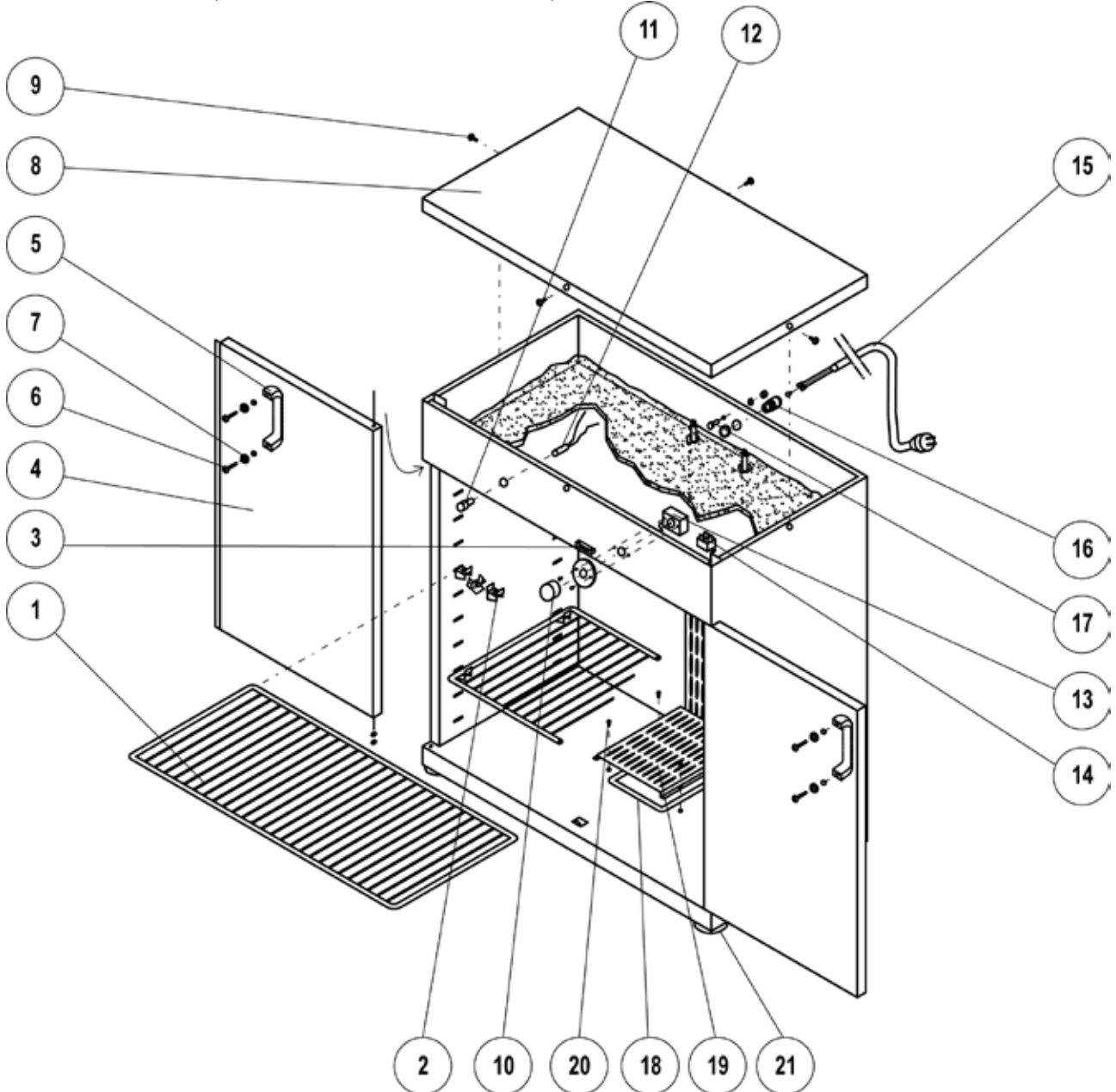

Telefoon (0317) 619 108

www.serviceteam.nl

SERVICE TEAM NEDERLAND

 **bedrijfskoeling**  **grootkeukens**  **witech catering equipment**

Rev. 04/2013

*The producer decline every responsibility on any print and/or transcription mistake contained in this booklet
The producer can change features and datas of this booklet with the proposal of keeping on increase the quality of its products.
Anytime and without notice, this booklet can't be considered as contract with third parties.*

5. Cleaning and maintenance

WARNING:



Before any cleaning operation unplug the device from the electrical system. Never wash the appliance with water jets in order to prevent water seepage inside the electrical components.



Before any cleaning operation wait for the appliance to be cooled down (wait at least one hour from the end of the service).

Use specific cleansers st. steel surfaces, in any case do not use abrasives.

The appliance is provided with a safety thermostat with automatic reset which interrupts the power supply in case of overheating.

The appliance resumes its normal operation with the standard operating temperature.

5.1 Breakdowns

<i>Problem</i>	<i>Possible reasons</i>	<i>Solution</i>
The hot box does not warm up	Power failure	Check the presence of power in the electric system
	Heating element is burned	Contact the retailer
	Thermostat is broken	Contact the retailer
	The power cable is worn-out	Replace the cable with a suitable one
The switch light does not light up	The hot box has reached the temperature	-
	The switch light is burned	Contact the retailer

5.2 Wiring diagram

<i>Ref.</i>	<i>Description</i>
TH	Thermostat 30-90°C
SP	Warming light
RES	Heating element

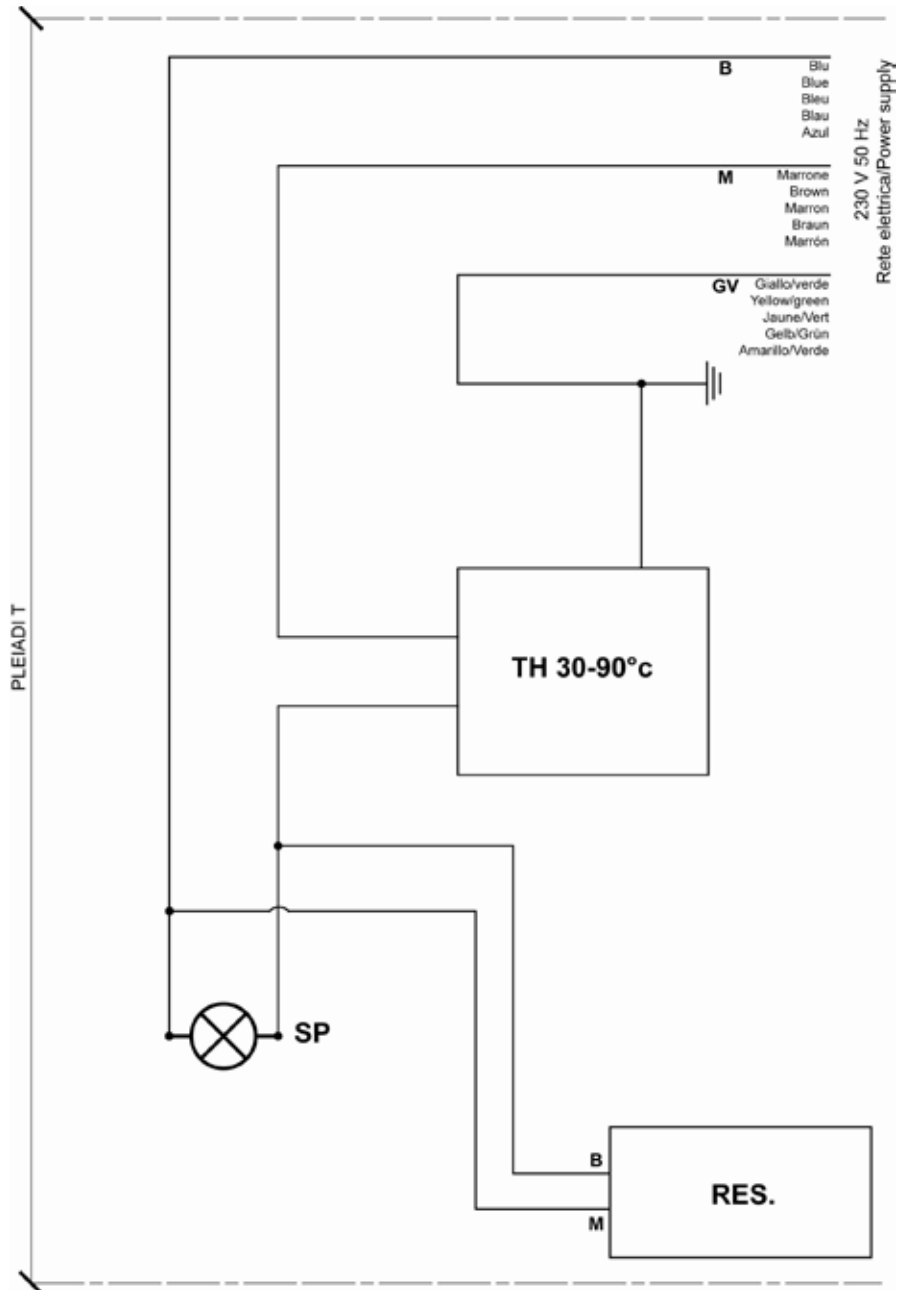

6. Disposal



This marking shown on the product or its literature, indicates that it should not be disposed with other household wastes at the end of its working life. To prevent possible harm to the environment or human health from uncontrolled waste disposal, please separate this from other types of wastes and recycle it responsibly to promote the sustainable reuse of material resources. Household users should contact either the retailer where they purchased this product, or their local government office, for details of where and how they can take this item for environmentally safe recycling. Business users should contact their supplier and check the terms and conditions of the purchase contract. This product should not be mixed with other commercial wastes for disposal.

Telefoon (0317) 619 108

www.serviceteam.nl

