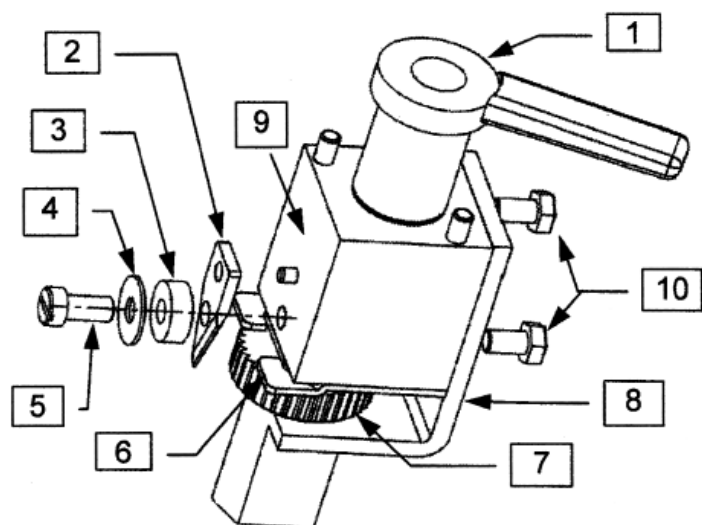

208.050 CAN-OPENER - MANUAL

No.	REF.	DESCRIPTION
	réf.	
1	02870	RILSAN LEVER
2	02830	BLADE
3	02873	COURBANE RING
4	OX873	ST/ST RING
5	02877	BLADE SCREW
6	02872	NICKELED STEEL PLAQUETTE
7	02820	COG-WHEEL
8	02810	BODY ALONE 02
9		SQUARE 02
10	02888	SCREW 6X10 FOR 02
	02840	HANDLE FOR CAN OPENER 02
	OX842	HANDLE + CLIP FOR 02
	02880	BED PLATE TO BE BOLTED EPOXY 02
	02890	CLAMP BASE EPOXY 02

ASSEMBLING OF THE CAN-OPEN;

- Fixe the standby bolting to the table with 4 screws.
- Fixe the stand with a clamp fixation. Tighten very hard so that the base can't move when you open a can.
- Fixe the stand with wall! fixation hang on the wall (about 70/80 cm height).
Put the can-opener in the place allowed in the base, the blade facing the base.

UTILISATION

Disengage the knurled wheel in displacing the rilsan lever to the left.

Lift the can-opener and place the can against the pillar.

Let the tool drop and push down so that the blade pierces the can lid

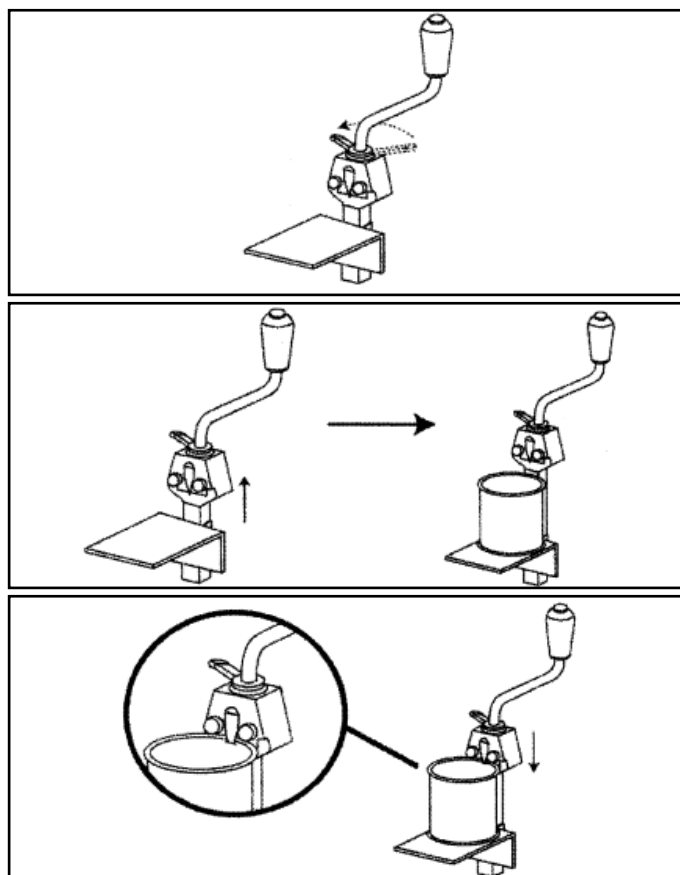

Tighten the knurled wheel with the rilsan lever
(in a clockwise direction).

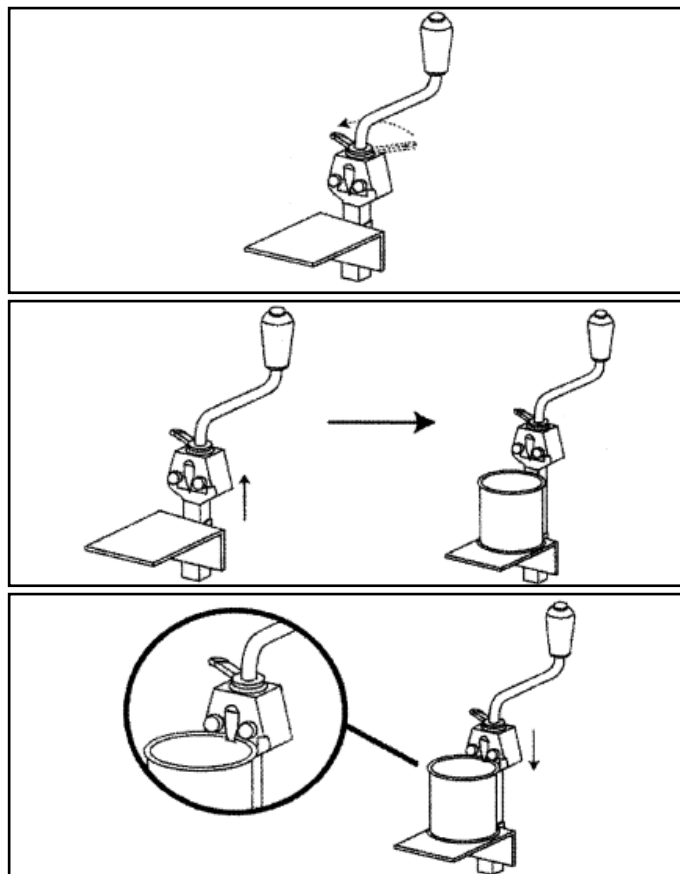
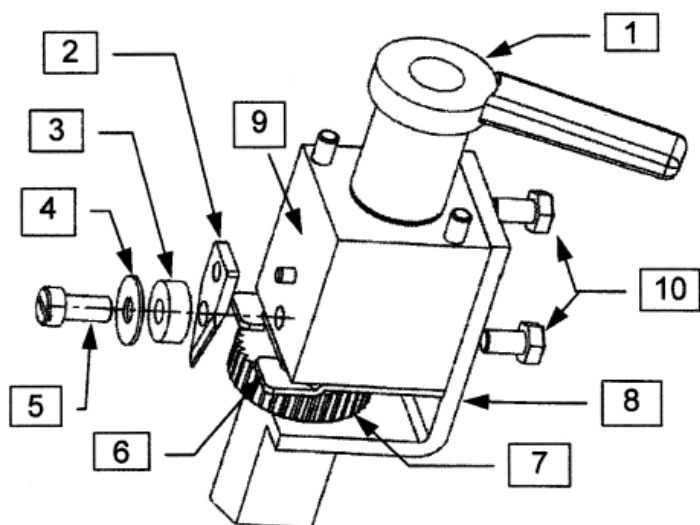

MAINTENANCE

CLEANING

Daily cleaning with a wet sponge, or in dish-washing machine.
Brush the cog-wheel regularly (a dirty cog-wheel can't drive the can).

BLADE

⚠ CAUTION: DO NOT SHARPEN THE BLADE

When the blade leaves metal silver, it is chipped or worn and you must return the blade or change it. You must loosen the screw, take out the rings and return the worn blade. Replace the rings and screw back the blade.

COG-WHEEL

To dismantle the wheel, insert it in seating and turn the handle in opposite clockwise direction. As the can-opener is dismantled, we advise you to clean the different parts of the can-opener (blade, cog-wheel, base). Put the new cog-wheel in seating with the engraved arrow on the top.

BAGUE EN RILSAN -RILSAN LEVER

To reach the rilsan lever, it is necessary to dismantle the cog-wheel (see above) and to withdraw the handle.

GUARANTEE

- The guarantee does not cover the-repairs due to:
Use not forecasted or abusive of the machine / deterioration due to a shock or a fall / assembling or dismantling not forecasted in the user's instructions.
- The guarantee does not cover the wearing parts (blade and cog-wheel) and applies within the framework of a normal use and maintenance.

Telefoon (0317) 619 108

www.serviceteam.nl

SERVICE TEAM NEDERLAND

bedrijfskoeling

grootkeukens

witech catering equipment